

Technology  
Connects human and nature

# SL7N-63

## MINIATURE DC CIRCUIT BREAKER

- Short-current interruption overload protection
- 6 kA High breaking capacity
- Reversible wiring, free of incorrect connection
- 63 A Rated working current
- Clearance  $\geq 9\text{mm}$ , swift arc breaking
- Maze arc-extinguishing room
- U shaped magnetic blowout enhances the extinguish ability
- 7 rivets guarantee wiring reliability
- Busbar makes the wiring safe and beautiful
- Specially designed appearance
- A range of optional accessories, suitable for DC products of PV or energy storage system



## MODEL NUMBER

Model Number	Pole	Trip Characteristic	Current (A)	Voltage	Wiring Mode	Item	Voltage		
SL7N-63	1P	B C	6 10 16 25 32 40 50 63	I:15V	-	Optional Accessory	OF 20F SD OF+SD	-	
				II:24V	-				
				III:48V	-				
				IV:60V	-				
				V:100V	-				
				VI:180V	-				
				rated:250V	-				
	2P			I:24V	H		MX MX+OF OF+MX+OF 20F+MX+OF SD+MX+OF OF+SD+MX OF+SD+MX+OF		I:DC12V II:DC24V-48V III:DC110V-400V IV:AC220V-380V
				II:48V	H				
				III:125V	H				
				IV:375V	H				
				rated:550V	H				
				III:600V	H				
				rated:800V	H				
				I:125V	G				
				II:375V	G				
				rated:550V	G				
				III:600V	G				
	3P			IV:800V	G		OF+MN SD+MN OF+SD+MN		AC230V AC400V
				rated:750V	H				
				I:800V	H				
	4P			rated:750V	G				
				I:800V	G				
				I:800V	H				
				rated:1000V	H				
				II:1200V	H				
				I:800V	G				
	rated:1000V			G					
II:1200V	G								

Suntree Model Number	Shell Frame Current	Rated Current	Pole	Rated Voltage	Wiring Mode	Accessory and Voltage
SL7N	-63	C32	2P	II	G	MX+OF I

SL7N-63 C32/4PIIGMX+OFI

DC Miniature Circuit Breaker 2P 40 A 600 V; C curve; up-out and down-in; DC12V MX+OF accessory

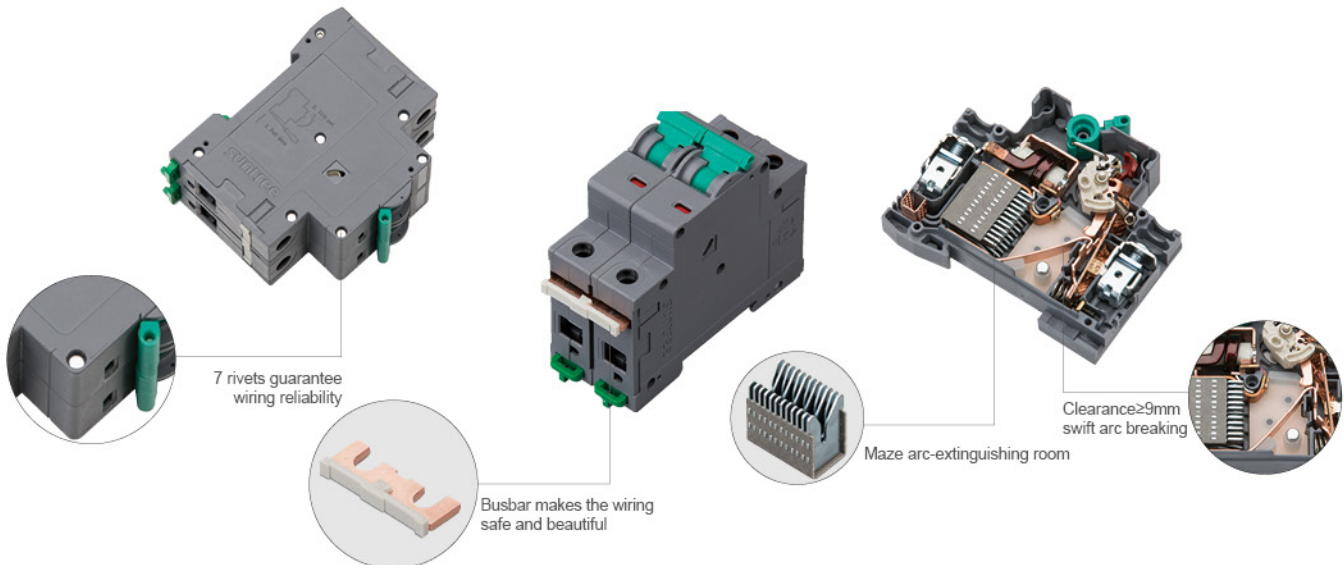

# SL7N-63

## MINIATURE DC CIRCUIT BREAKER

### PARAMETERS

Item	Parameter
Rated Insulation Voltage (Ui)	1250 V
Rated Operational Voltage (Ue)	DC(1P):15V,24V,48V,60V,100V,180V,250V ; DC(2P):24V,48V,125V,375V,550V,600V,800V DC(3P):750V,800V ; DC(4P):800V,1000V 1200V
Rated Shell Frame Current	63 A
Current (In)	6 A 10 A 16 A 20 A 25 A 32 A 40 A 50 A 63 A
Pole	1P 2P 3P 4P
Rated Short Circuit Breaking Capacity (Ics)	6 kA/H
Rated Ultimate Short Circuit Breaking Capacity (Icu)	6 kA/H
Mechanical Life	20000 times
Electrical Life	<DC125 V/1P or <DC250 V/2P: 10000 times; other voltage: 1500 times
Certification	
Fishbone Busbar and Wire Connector	YES
Rated Impulse Withstand Voltage (Uimp)	6 kV
Trip Characteristics	B/C
Trip Type	thermo-magnetic
Overvoltage Category	III
Pollution Degree	3
Protection Degree	IP40; IP20 (seam)
Damp Heat Resistance	type 2
Relative Humidity	≤95%
Standard	IEC 60947-2 GB/T 14048.2
Vibration Resistance	According to IEC60068-2-6
Mechanical Shock Resistance	According to IEC60068-2-27
Working Temperature	-30°C to 70°C
Damp Heat Resistance (IEC 60068-4)	Db ( 6 cycles at 55°C )
Storage Temperature	-40°C to 85°C
Installation	DIN
Altitude	≤2000
Weight	0.12 kg/P
Accessory	OF/SD/MX/MN/MX+OF
MX Us	DC:12V, 24V, 220V; AC:110V,220V,380V; Power Supply recommended over 75W
MN Un	AC 220 V AC 380 V

# SL7N-63

## MINIATURE DC CIRCUIT BREAKER

### WIRING

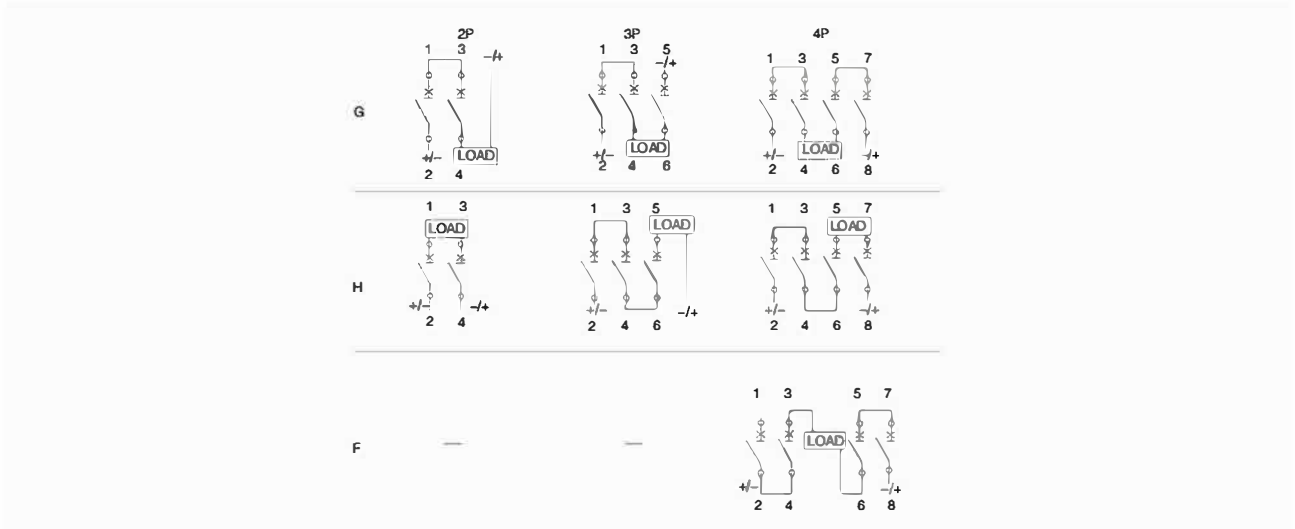

### INSTALLATION

This product is installed with 35 mm DIN rail. No additional tool needed, simply buckle the product into the rail. Please put the upper hook of the bottom into the rail first, making the product angled about 30°. Then press down to buckle it. When you finish, the product should stay vertical as shown in the right picture.

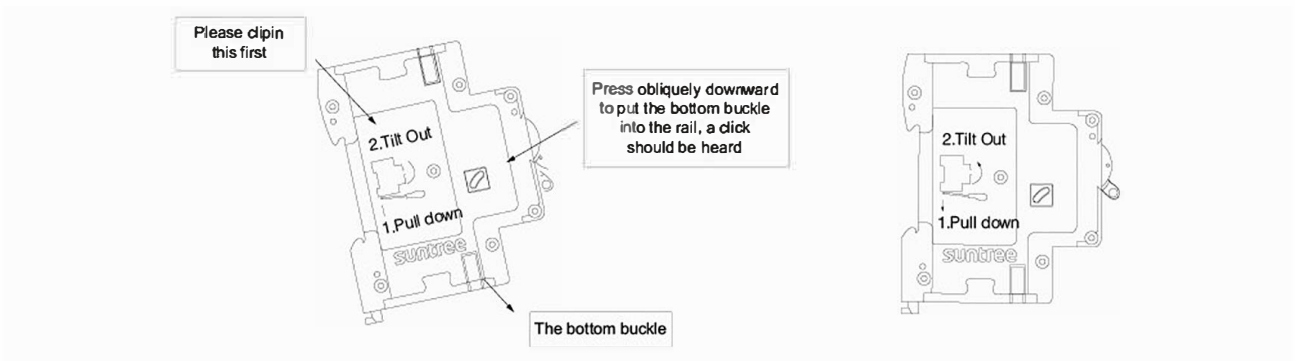

### DISMANTLING

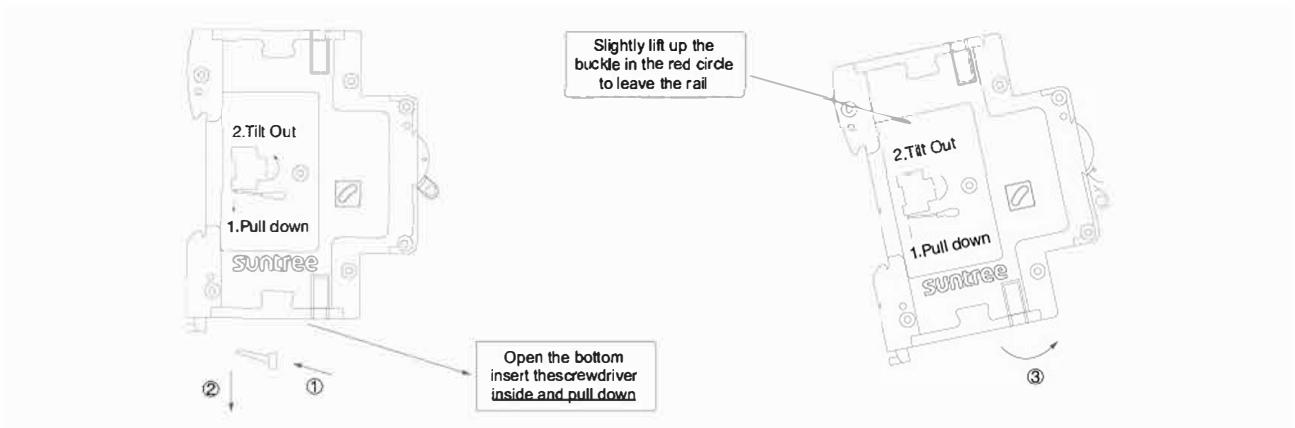



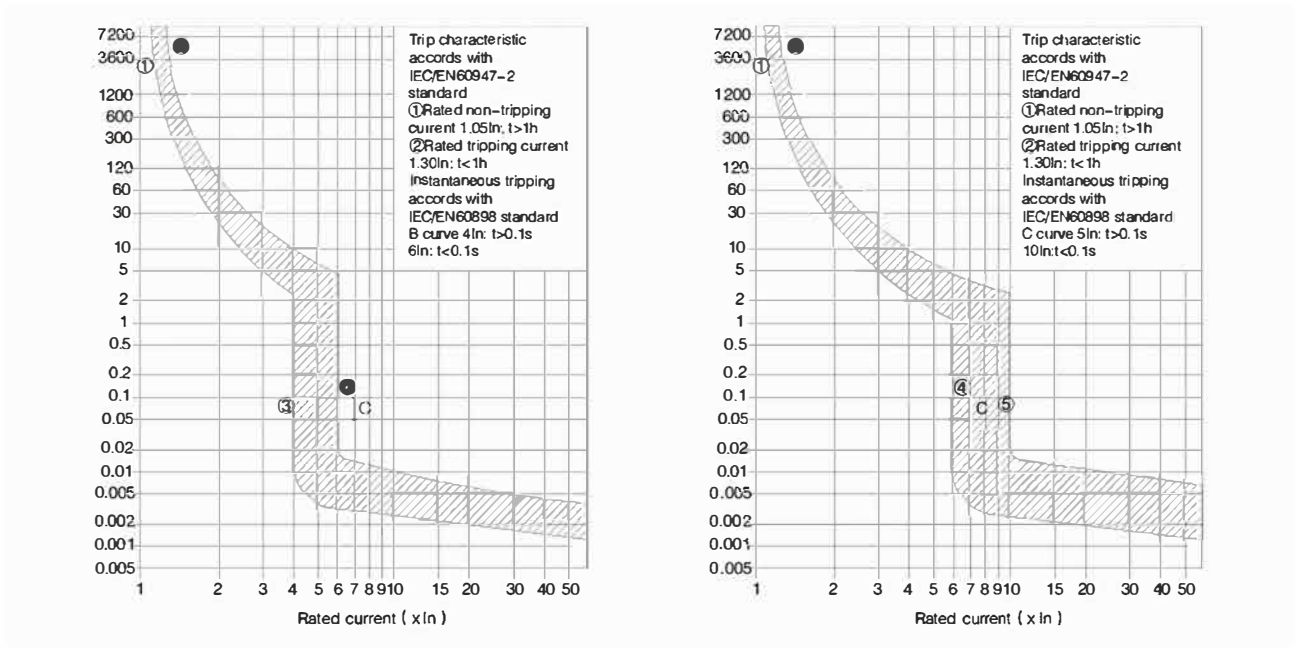

# SL7N-63

## MINIATURE DC CIRCUIT BREAKER

### TRIP CHARACTERISTIC



### WIRING CAPACITY

project name	diagram
Wiring tool 	
Wiring Capacity (mm <sup>2</sup> ) 	1-25 mm <sup>2</sup> (mm <sup>2</sup> )
Tightening torque (Nm) 	2-2.3 Nm (Nm)

### APPEARANCE AND MOUNTING DIMENSION

